

QUARTER TURN ELECTRIC ACTUATOR

AVA-60.10 SMART ON-OFF 60Nm



Model	AVA60.10 60Nm SMART ON-OFF ELECTRIC ACTUATOR		
Rated Voltage	95-265V AC	24VAC/ DC	
Voltage Range	AC 90-130V 50/60Hz	DC 22-28V	
Consumption	55W run, 0.52W hold	24W run, 0.5W hold	
Peak current	0.6A for 5ms	2.5A for 5ms	
Fuse	5A	5A	
Maximum Break Torque Nm	60	60	
Run & Reseat Torque Nm	60	60	
Run time (90°)	≈ 15 sec	≈ 10 secs	
STANDARD FEATURES:			
Operating frequency	AC: Not continuous, 75% duty cycle but recommended to allow ≥ 1 minute between cycles. DC: Continuous		
Position sensing	Magnetic with digital sensing. No mechanical cams fitted.		
Maximum angle of rotation	90° 180° °		
Position indication (visual)	2 colour (red/ yellow) dome for local visual confirmation		
End Position indication	2 x Electronic relay		
Mounting restriction	None, can be mounted at any angle. Leave room for space to operate manually, and for electrical connection		
ISO:5211	F05 & F07		
Female drive	17mm octagon x 15mm deep		
Manual operation	Yes, by hexagonal wrench (supplied in clip) when no power is being applied		
Ingress protection	IP67		
Max media temp	≤ 80C		
Ambient temp	-20 to +60C		
Non-operating temp	≤ -40C to ≥80C		
Ambient humidity	5-95% RH non-condensing		
Explosion proof	No, absolutely prohibited. Do not use in hazardous areas		
Shock Resistance	≥300m/S2		
Vibration	10 to 55Hz, 1.5mm double amplitude (product damage most likely if exceeded)		
Noise level	Around 50dB		
Flame Retardant Level	V0 using the UL94 Test method		
Certification	CE		
Maintenance	Maintenance free		
Cable Entry	1 x Nickel plated brass		
Housing	ABS		
Weight	2.7Kg		

Direct mount [female octagonal output shaft]

unit: mm

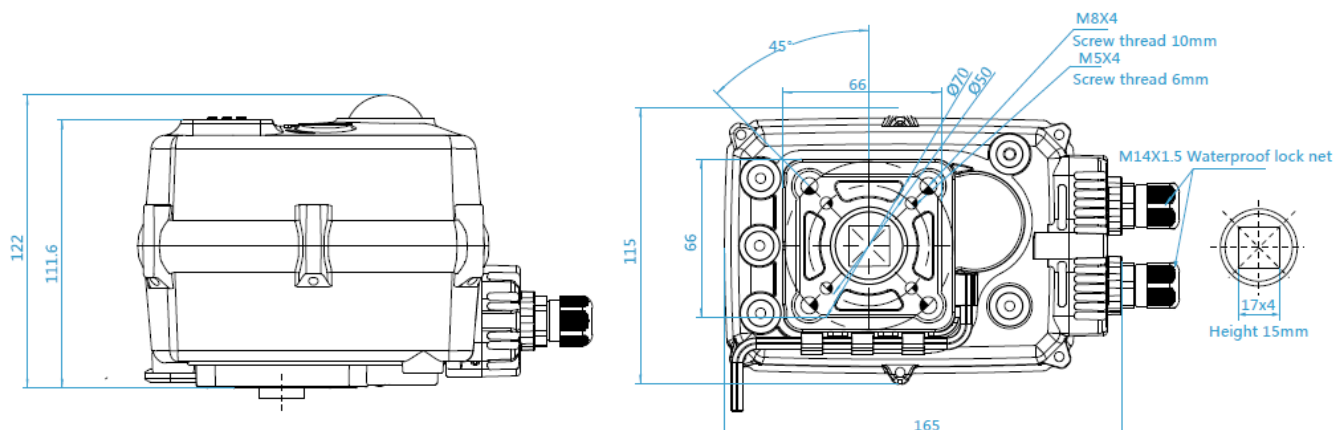

PART NUMBERING



Model	Voltage	Cover	Heater	Control of on-off function and end of travel confirmation
AVA-S60.10-	5 AC 95-265V	A Aluminium	0 None	A SPDT. Switchable +ve/ live with volt free confirmation
	6 AC 110V		H 5W/24kΩ	B SPDT. Switchable +ve/ live with volt free confirmation & Alarm
				C SPST. Make to open, break to close with volt free confirmation
				D SPST. Make to open, break to close with volt free confirmation & Alarm
				E SPDT. Switchable +ve/ live with relay confirmation
				F SPDT. Switchable +ve/ live with relay confirmation Alarm
				G SPST. Make to open, break to close with relay confirmation
				H SPST. Make to open, break to close with relay confirmation & Alarm

NOTE: UK STANDARD STOCK IS WITH WIRING 'A', ANY OTHERS ARE FACTORY OPTIONS.

STANDARD WIRING DIAGRAM

AVA-S60.10 60Nm SMART ON-OFF ELECTRIC ACTUATOR



AVA-S60.10 ON-OFF WIRING 'E'

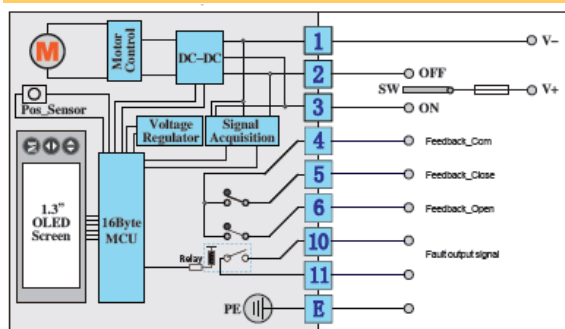

SW	Valve Position	Confirmation	Notes
OFF	Closed	4 & 5 connected	No signal mid-travel
ON	Open	4 & 6 connected	

NOTE: UK STANDARD STOCK IS WIRING 'A', OTHERS ARE FACTORY OPTIONS. WIRING 'A' IS THE SAME AS 'B' SHOWN HERE EXCEPT IT DOES NOT HAVE THE RELAY POWERED FAULT CIRCUIT INSTALLED (TERMINAL POSITIONS 10 & 11)

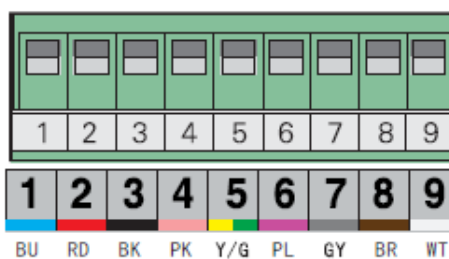

The New 60 and 110 Series has new wiring box that provides the terminal block as shown here.

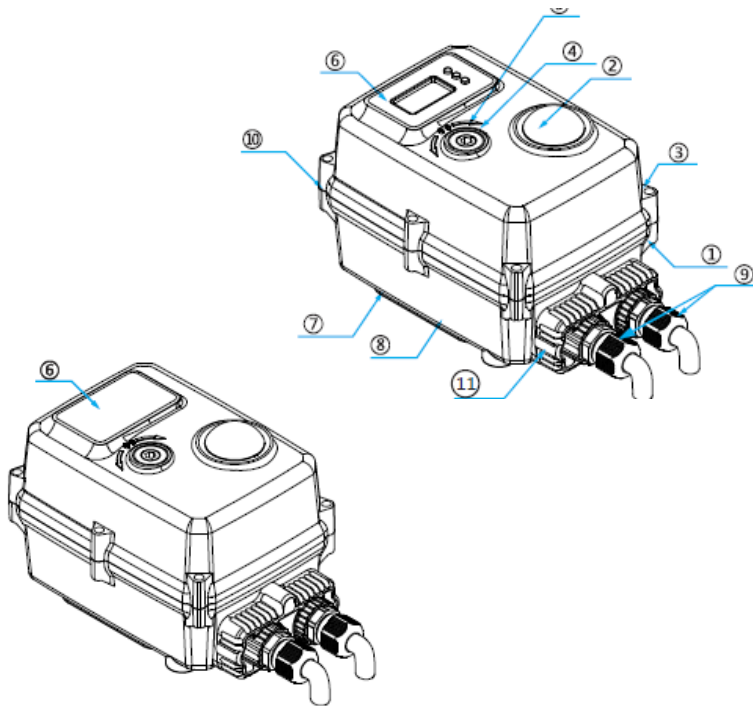

No	PART	MATERIAL
1	Housing	ABS
2	Indicator	Transparent AS
3	Cover screws	304SS
4	Override drive	304SS
5	Seal	NBR
6	Output drive	SS304
7	Seal	NBR
8	Connector	Plastic
9	Cover seal	NBR
10	Seal	NBR
11	Label	PVC
12	Allen key	Tool steel
13	Terminal box	Heatproof ABS
14	Screen	OLED

Overview: All AVA smart electric actuators have local controls as standard which combine an OLED screen and 3 positive feel push buttons to create local control and a variety of user friendly adjustments. The bright screen with blue letters on a black background are easy to read, and the use of the push buttons to adjust settings is intuitive. The local controls require power to be applied to the actuator to operate.

Local controls:



M button is used to enter and switch menus.

K2 is used in conjunction with K3 for adjusting values.

K3 is used for changing settings, navigating menus, exiting and saving.

OLED Screen with clear blue letters against a black background

Standard local control function options:

MANUAL CONTROL	The AVA smart actuator can be opened and closed using the K2 and K3 buttons
DEAD BAND	Adjusts the accuracy and sensitivity
SPEED CONTROL	The working time can be increased either by setting a step timer (run/stop/run/stop), or continuous running adjusting the PWM
CLOSED POSITION	Small adjustments can easily and quickly be made to the final close position angle (zero adjustment).
REVERSE ACTING	Receiving an open command signal sends the AVA smart actuator to the closed position and vice versa
EXTEND ANGLE	Adjust the open position by adjusting the span. Typically used to set 0-180 degree operation
3 POSITIONS	Sets the 3rd position (where wiring allows)